

## Protecta FR Acrylic - Concrete Wall Metal Pipe, Interrupted Insulation

System/FPA Register ID# FC116

### Installation Instructions

- Before installing Protecta® FR Acrylic ensure that the surface of all service penetrations and surrounding construction is free from all loose contaminants, dust and grease.
- Where Protecta® FR Acrylic is to be installed against surfaces that cannot tolerate direct contact; appropriate surface preparation should be made (contact Polyseam for guidance in these cases). For paints sensitive to sealing compounds, priming with a PVA primer is recommended.
- As Protecta® FR Acrylic is water based, in cases where corrosion protection is a problem; some metals may require a barrier between the sealant and the metal surface prior to this installation.
- When installing any backing material, cut this slightly oversize and insert into the gap ensuring a tight friction fit. Ensure correct depth is achieved.
- Fill the gap or joint with Protecta® FR Acrylic to the required depth.
- Apply the sealant generously to prevent air bubbles. Finish the bead with a moist spatula, pallet knife or brush.
- Protecta® FR Acrylic can be over-painted with most emulsion or alkyd (gloss) paints.

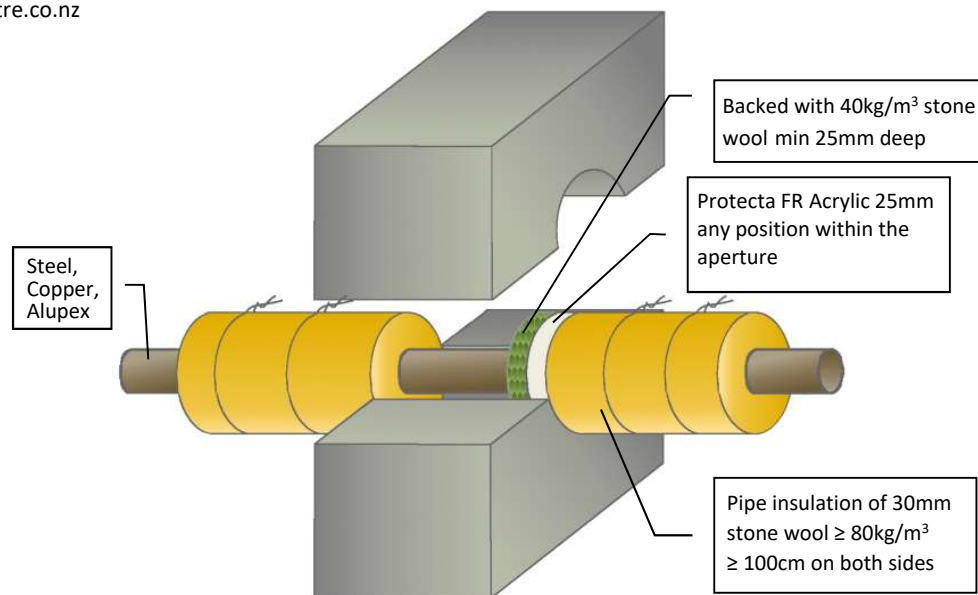

Services	Aperture	Classification
≤ Ø219mm Steel	300x300mm	FRR -/240/60
≤ Ø40mm Steel	6-18mm annular	FRR -/240/240
≤ Ø219mm Steel	6-18mm annular	FRR -/180/90
≤ Ø54mm Copper	300x300mm	FRR -/240/60
≤ Ø54mm Copper	8-9mm annular	FRR -/240/180
≤ Ø12mm Copper	8mm annular	FRR -/240/240
≤ Ø75mm Alupec Composite	300x300mm	FRR -/240/60
≤ Ø75mm Alupec Composite	30mm annular	FRR -/120/120

<b>Products</b>	Protecta FR Acrylic Stone wool
<b>Application</b>	Fire stopping of CI/LI metal or alupec pipes in rigid walls.
<b>Construction</b>	Minimum wall thickness of 150mm and comprise concrete, aerated concrete or masonry, with a density of ≥ 650 kg/m³

### Fire & Sound classification

See table for FRR ratings and aperture sizes

Wall thickness may be reduced to a minimum of 75mm with FRR of system reduced to FRR of the wall.

All single-sided systems shown cover fire from either direction.

All systems shown may be applied to bare pipes with the Insulation rating reduced to zero

ZERO smoke leakage up to 200Pa

Sound reduction (seal only) STC 62

As a part of our policy of on-going product development and testing, we reserve the right to modify, alter or change product specifications without giving notice. All information contained in this document is given in good faith and is provided for guidance only. Any drawings provided are for illustrative purposes only. As Polyseam has no control over the methods or competence of installation and of prevailing site conditions, no warranties, expressed or implied, is intended to be given as to the actual performance of the product mentioned or referred to herein and no liability whatsoever will be accepted for any loss, damage or injury arising from the use of the information given.

For all technical details on the products specified please refer to the technical data sheets that can be found on [www.firestopcentre.co.nz](http://www.firestopcentre.co.nz)

Signed and approved:

Sheet size: <b>A4</b>	Drawn date & no: 24/5/21
Scale: <b>NTS</b>	Drawn by: K.B